

# Clarke<sup>®</sup>

## air



## 24" INDUSTRIAL HIGH OUTPUT FAN MODEL NO: CAM5002

PART NO: 3231550

### OPERATION & MAINTENANCE INSTRUCTIONS



1118 - ISS 4

---

## INTRODUCTION

---

Thank you for purchasing this CLARKE 24" Industrial high output fan.

Before using, please read this manual thoroughly and follow the instructions carefully. In doing so you will ensure the safety of yourself and others, and you can look forward to your purchase giving you long and satisfactory service.

---

## GUARANTEE

---

This product is guaranteed against faulty manufacture for a period of 12 months from the date of purchase. Please keep your receipt which will be required as proof of purchase.

This guarantee is invalid if the product is found to have been abused or tampered with in any way, or not used for the purpose for which it was intended.

Faulty goods should be returned to their place of purchase, no product can be returned to us without prior permission.

This guarantee does not effect your statutory rights.

---

## ENVIRONMENTAL RECYCLING POLICY

---



Through purchase of this product, the customer is taking on the obligation to deal with the WEEE in accordance with the WEEE regulations in relation to the treatment, recycling & recovery and environmentally sound disposal of the WEEE.

In effect, this means that this product must not be disposed of with general household waste. It must be disposed of according to the laws governing Waste Electrical and Electronic Equipment (WEEE) at a recognised disposal facility.

---

## SPECIFICATIONS

---

Voltage:	230 VAC (50Hz)
Wattage:	250 W
Fan Speeds	3
Dimensions (L x W x H):	735 x 340 x 835 mm
Weight:	245 kg

---

## ELECTRICAL CONNECTIONS



**WARNING! Read these electrical safety instructions thoroughly before connecting the product to the mains supply.**

Before switching the product on, make sure that the voltage of your electricity supply is the same as that indicated on the rating plate. This product is designed to operate on 230VAC 50Hz. Connecting it to any other power source may cause damage.

This product may be fitted with a non-rewireable plug. If it is necessary to change the fuse in the plug, the fuse cover must be refitted. If the fuse cover becomes lost or damaged, the plug must not be used until a suitable replacement is obtained.

If the plug has to be changed because it is not suitable for your socket, or due to damage, it should be cut off and a replacement fitted, following the wiring instructions shown below. The old plug must be disposed of safely, as insertion into a mains socket could cause an electrical hazard.



**WARNING! The wires in the power cable of this product are coloured in accordance with the following code:  
Blue = Neutral    Brown = Live    Yellow and Green = Earth**

If the colours of the wires in the power cable of this product do not correspond with the markings on the terminals of your plug, proceed as follows.

- The wire which is coloured **Blue** must be connected to the terminal which is marked **N** or coloured **Black**.
- The wire which is coloured **Brown** must be connected to the terminal which is marked **L** or coloured **Red**.
- The wire which is coloured **Yellow and Green** must be connected to the terminal which is marked **E** or  or coloured **Green**.

**Plug must be BS1363/A approved.**

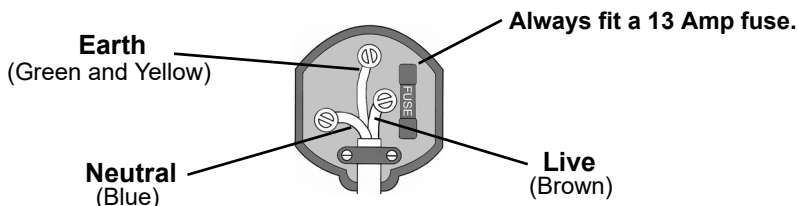

**Ensure that the outer sheath of the cable is firmly held by the clamp**

We strongly recommend that this machine is connected to the mains supply via a Residual Current Device (RCD)

If in any doubt, consult a qualified electrician. DO NOT attempt any repairs yourself.

---

## **SAFETY PRECAUTIONS**

---

- DO NOT use in dusty environments.
- Indoor use only.
- DO NOT use in environments with high fumes from chemicals etc.
- DO NOT use as an extractor fan.
- DO NOT use in areas of high humidity/water vapour, e.g. bathrooms.
- DO NOT connect fan to a ducting system.
- DO NOT cover the fan with any material that will restrict free airflow.
- Never touch the blades with your hand or any other object.

---

## **CONTENTS**

---

Before assembly, check for damage and or shortages etc, if any are found contact your Clarke dealer where the fan was originally purchased.

1 x Fan Assembly	2 x Rubber Feet With Mounting Brackets
2 x Moulded Wheels	1 x Ceiling Mounting Bracket
3 x M12 Screws	3 x 12mm Plain Washers
1 x Handle	

---

## **ASSEMBLY & OPERATION**

---

### **FLOOR MOUNTING**

1. Fit handle (item 13) to the fan housing (item 11) using screws x 2 (item 12).
2. Fit wheels x 2 (item 22) to the frame using shoulder screws x 2 (item 20) and washers x 2 (item 21).
3. Fit feet brackets x 2, (item 27) using screws x 4 (item 28) and washers x 4 (item 29).
4. Fit feet x 2 (item 26) onto brackets using screws x 2 (item 24) and washers x 2 (item 25).
5. Plug in and switch on. adjust the fan speed to suit.

## CEILING MOUNTING

Choose location for the fan installation, ensuring correct electric supply is available.

1. Use the ceiling mounting plate (item 23) as a template, to mark drilling locations.
2. Drill holes in ceiling to suit suitable fixings, not supplied.
3. Fix the ceiling mounting plate to the ceiling using appropriate fixings, not supplied.  
Ensure the mounting plate is secured sufficiently to take the weight of the fan.
4. Attach the fan to the mounting plate using screws supplied, (item 30).
5. Adjust the fan to desired position then tighten all three securing screws.
6. Plug in and switch on, adjust the fan speed to suit.

**NOTE:** all parts not used for ceiling mounted fans, should be stored safely for use if the fan is to be floor mounted

## ADJUSTING THE SPEED



**WARNING: NEVER OPERATE THE FAN WITH EITHER FRONT OR REAR GRILLS REMOVED.**

Plug in the power cable to an appropriate power outlet and select the desired speed using the selector switch 0/1/2/3.

0	Off
1	Low speed
2	Medium speed
3	High speed

## MAINTENANCE

- Always observe the safety precautions and remove the plug from the power outlet before cleaning.
- Use a moist cloth and if required, a mild detergent to clean the surfaces of the fan. Do not use solvents or thinners.
- The motor bearings are permanently sealed and do not require any additional lubrication.

# PART LIST AND DIAGRAM

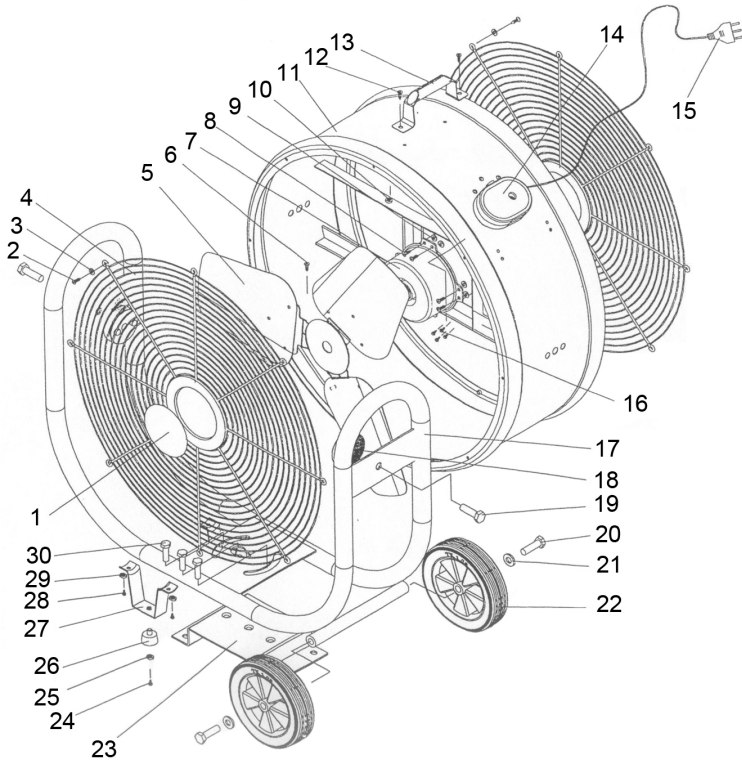

NO	DESCRIPTION	NO	DESCRIPTION	NO	DESCRIPTION
1	Name plate	11	Drum Fan Housing	21	Washer 1 2mm
2	Screw M18 x 12	12	Screw M6 x 10	22	Wheel
3	Washer 5mm	13	Handle	23	Ceiling Mounting Plate
4	Grill	14	Switch Box	24	Screw M5 x 10
5	Fan blade	15	Power Cord & Plug	25	Washer 5mm
6	Screw 10 x 13	16	Screw ST4 x 12	26	Foot
7	Motor	17	Frame	27	Bracket
8	Screw M6 x 12	18	Shock Absorber	28	Screw M6 x 12
9	Nut M6	19	Screw M1 2 x 35	29	Washer
10	Nut M8	20	Screw M12 x 70	30	Screw M 12 x 20

# DECLARATION OF CONFORMITY



**Clarke**<sup>®</sup>  
**INTERNATIONAL**

Hemnoll Street, Epping, Essex CM16 4LG

## DECLARATION OF CONFORMITY

**This is an important document and should be retained.**

**We hereby declare that this product(s) complies with the following directive(s):**

2014/30/EU *Electromagnetic Compatibility Directive.*

2014/35/EU *Low Voltage Equipment Directive.*

2011/65/EU *Restriction of Hazardous substances.*

**The following standards have been applied to the product(s):**

*EN 61000-3-2:2014, EN 62233:2008, EN 55014-1:2017, EN 55014-2:2015, EN 61000-3-3:2013,*

*EN 60335-1:2012+A11:2014+A13:2017, EN 60335-2-80:2003+A1:2004+A2:2009.*

The technical documentation required to demonstrate that the product(s) meet(s) the requirement(s) of the aforementioned directive(s) has been compiled and is available for inspection by the relevant enforcement authorities.

The CE mark was first applied in: 2005

**Product Description:** 30" Drum Fan  
**Model number(s):** CAM6000  
**Serial / batch Number:** N/A  
**Date of Issue:** 15/11/2018

**Signed:**

  
.....  
**J.A. Clarke**  
**Director**

# A SELECTION FROM THE VAST RANGE OF

# Clarke®

## QUALITY PRODUCTS

### AIR COMPRESSORS

From DIY to industrial, Plus air tools, spray guns and accessories.

### GENERATORS

Prime duty or emergency standby for business, home and leisure.

### POWER WASHERS

Hot and cold, electric and engine driven - we have what you need

### WELDERS

Mig, Arc, Tig and Spot. From DIY to auto/industrial.

### METALWORKING

Drills, grinders and saws for DIY and professional use.

### WOODWORKING

Saws, sanders, lathes, mortisers and dust extraction.

### HYDRAULICS

Cranes, body repair kits, transmission jacks for all types of workshop use.

### WATER PUMPS

Submersible, electric and engine driven for DIY, agriculture and industry.

### POWERTOOLS

Angle grinders, cordless drill sets, saws and sanders.

### STARTERS/CHARGERS

All sizes for car and commercial use.



**PARTS & SERVICE: 0208 988 7400**

**E-mail: [Parts@clarkeinternational.com](mailto:Parts@clarkeinternational.com) or [Service@clarkeinternational.com](mailto:Service@clarkeinternational.com)**

**SALES: UK 01992 565333 or Export 00 44 (0)1992 565335**

**Clarke® INTERNATIONAL** Hemnall Street, Epping, Essex CM16 4LG  
[www.clarkeinternational.com](http://www.clarkeinternational.com)